

## LOCALITY PLAN

SCALE: NTS

PROJECT : MANAGING COASTAL AQUIFERS (MCAP), WOTJE

LOCATION : WOTJE, REPUBLIC of MARSHALL ISLAND

JOB NO : 22307117

CLIENT :



CONSULTANT:



**NRW MACALLAN (FIJI) LTD**  
CONSULTING ENGINEERS

CIVIL, STRUCTURAL, ELECTRICAL, MECHANICAL & PROJECT MANAGEMENT  
79 RATU MARA ROAD, SAMABULA, SUVA  
P. O. BOX 1208, SUVA  
PHONE: (679) 3313 388, FAX: (679) 3302903  
EMAIL: info@nrwmacallan.com.fj

### DRAWING SHEET SCHEDULES

SHEET No.	SHEET TITLE	REV	DATE
G-001	COVER SHEET	0A	5-Oct-23
A-001	GALLERY TANK OVERHEAD FLOOR PLAN, BEAM LAYOUT AND SECTIONS PIPEWORK DETAILS	0A	5-Oct-23
A-002	FOUNDATION PLAN	0A	5-Oct-23
A-003	HEADER TANK, INLET PIPE WORK ELEVATIONS (BE & SE1)	0A	5-Oct-23
A-004	HEADER TANK, INLET PIPE WORK ELEVATIONS (FE & SE2)	0A	5-Oct-23
A-005	GALLERY TANK SECTION	0A	5-Oct-23
A-006	GENERAL PIPE WORK DETAILS	0A	5-Oct-23
A-007	GALLERY PUMP PIPE WORK SECTION (TYP.)	0A	5-Oct-23
A-008	GALLERY SECTION AND DETAIL	0A	5-Oct-23
A-009	COLUMN STRUCTURAL DETAILS, PAD FOOTINGS & TYPICAL SECTIONS	0A	5-Oct-23
A-010	COMMUNITY FILLING POINT SITE PLAN & TYPICAL SECTION	0A	5-Oct-23
A-011	SAFETY ACCESS CAGE LADDER AND TYPICAL HANDRAIL ELEVATIONS, SECTIONS AND DETAILS	0A	5-Oct-23

Design amended to exclude

Design amended to exclude

Design amended to exclude

Design amended to exclude

Design amended to exclude

Design amended to exclude

Design amended to exclude

DO NOT SCALE - IF IN DOUBT, ASK

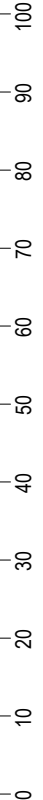

Copyright © of this drawing shall remain the property of NRW MACALLAN. No part of this document may be reproduced or transmitted by any means without the prior permission in writing of NRW MACALLAN Ltd. ORIGINAL SIZE A1

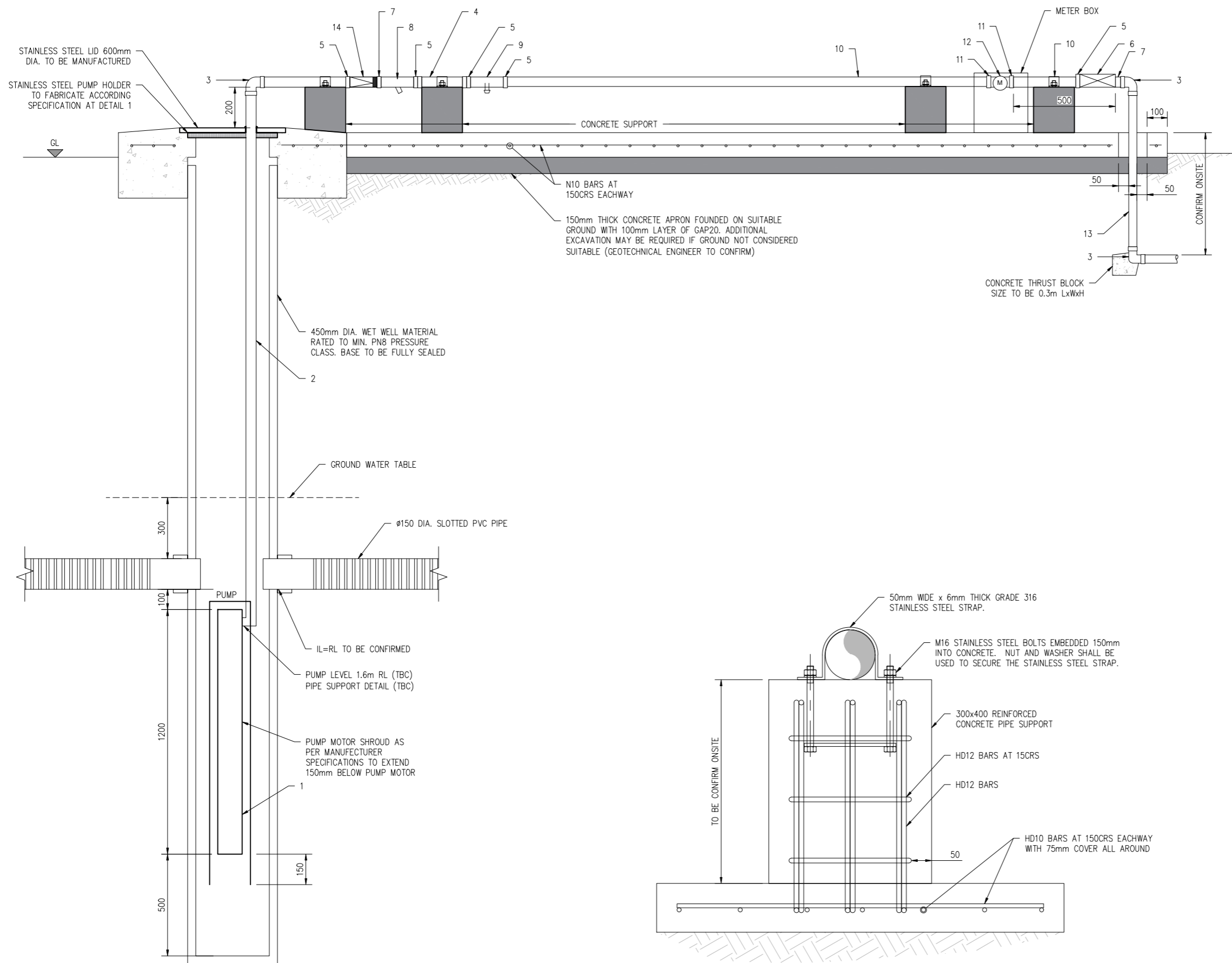

- NOTE:**
1. ALL DIMENSION ARE IN MILLIMETERS UNLESS NOTED OTHERWISE.
  2. ALL EXPOSED PIPELINE ARE TO BE POLYETHYLENE.
  3. PIPEWORK TO CONNECTED WITH PE COMPRESSION FITTINGS UNLESS NOTED OTHERWISE.
  4. ALL PE PIPE WORK AND FITTINGS TO BE CLASS PE100 SDR21 P8, UNLESS NOTED OTHERWISE.
  5. PIPEWORK TO BE CONNECTED WITH APPROVED COMPRESSION FITTINGS.
  6. ALL STEEL PIPE WORK AND FITTINGS TO BE CLASS MARINE GRADE UNLESS NOTED OTHERWISE.
  7. CONCRETE IS TO BE 30MPa STRENGTH.
  8. PLASTIC DAMP PROOF COURSE (DPC) SHEETING PROVIDED BETWEEN ALL CONCRETE AND SOIL INTERECTION.

**LEGEND:**

No.	DESCRIPTION
1	SUBMERSIBLE PUMP, LORENTZ PS2-1800 HRE 32 HELICAL ROTAR PUMP, EC DRIVE AND CONTROLLER, ASSOCIATEDFITTINGS INCLUDING CABLING AND ACCESSORIES
2	50 OD PE100 SDR21 P8 PIPE
3	50mm 90 DEG. POLYETHYLENE ELBOW SOCKET
4	50 OD PE100 SDR21 P8 PIPE
5	50mm TO 2" BSP POLYETHYLENE MALE ADAPTOR
6	2" BSP THREADED FEMAIL LOCKABLE BRASS BALL VALVE
7	2" BSP MALE THREADED NIPPLE
8	50mm FEMALE POLY Y-STRAINER WITH SS MESH
9	50mm POLY FEMALE TEE WITH 1" MALE THREAD OFFTAKE AND BIP TAP
10	50 OD PE100 SDR21 P8 PIPE
11	50mm TO 2" BSP POLYETHYLENE MALE ADAPTOR
12	25mm MULTI JET FLOE METER WITH 30mm (1 & 1/4") FEMALE THREADED EACH SIDE
13	50 OD PE100 SDR21 P8 PIPE
14	50 mm CHECK VALVE

**1 PUMP PIPE WORK**  
A-103 SCALE 1:10

**TYPICAL SUPPORT DETAIL**  
SCALE 1:5

DO NOT SCALE - IF IN DOUBT, ASK

100  
90  
80  
70  
60  
50  
40  
30  
20  
10  
0

ORIGINAL SIZE A1

Copyright © of this drawing shall remain the property of NRW MACALLAN. No part of this document may be reproduced or transmitted by any means without the prior permission in writing of NRW MACALLAN Ltd.

ISSUE	DESCRIPTION	CHECKED	APPROVED	DATE
0A	FOR TENDER	HS	NK	18.10.23

Client:

**Pacific Community**  
Communauté du Pacifique

**NRW MACALLAN (FIJI) LTD**  
CONSULTING ENGINEERS

CIVIL STRUCTURAL & PROJECT MANAGEMENT  
79 RATU MARA ROAD, SUVA  
P.O. Box 1208  
SUVA  
FIJI

TELEPHONE: (679) 3313388  
MOBILE: (679)  
FAX: (679) 3302903  
EMAIL: info@nrwmacallan.com.fj

Drafter:	HT	Designed:	-
Checked:	HSNK	Date:	23.08.23
Scale A1:	AS SHOWN	Scale A3:	HALF SHOWN

PROJECT: MANAGING COASTAL AQUIFERS (MCAP), WOTJE, MARSHALL ISLAND

TITLE: **GALLERY PUMP PIPE WORK SECTION**  
**CHAMBER REINFORCEMENT DETAIL**

JOB. NO:	<b>22307117</b>
REV. NO:	0A
DRAWING. NO:	A-007

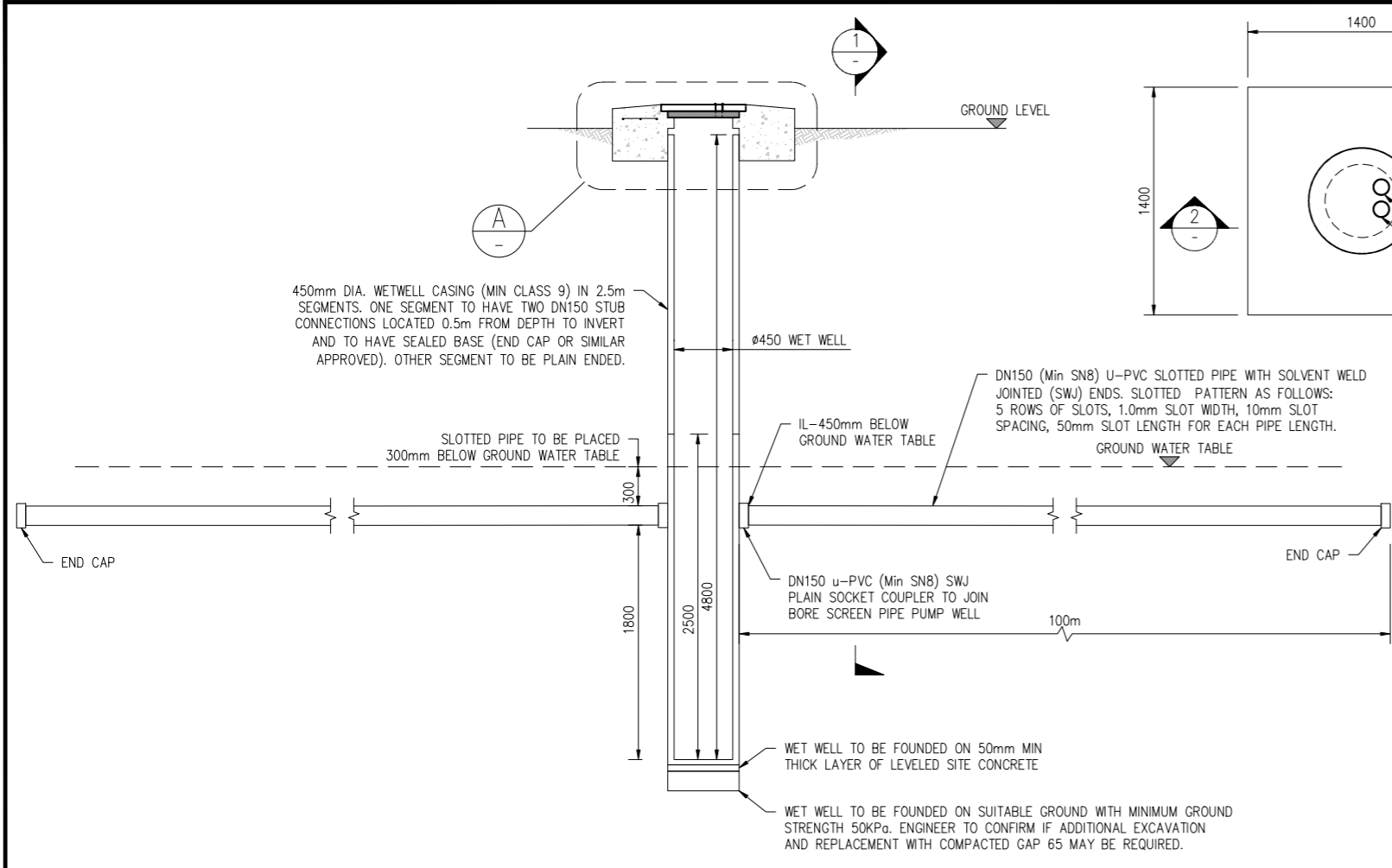

**INFILTRATION GALLERY GENERAL ELEVATION**  
SCALE 1:25

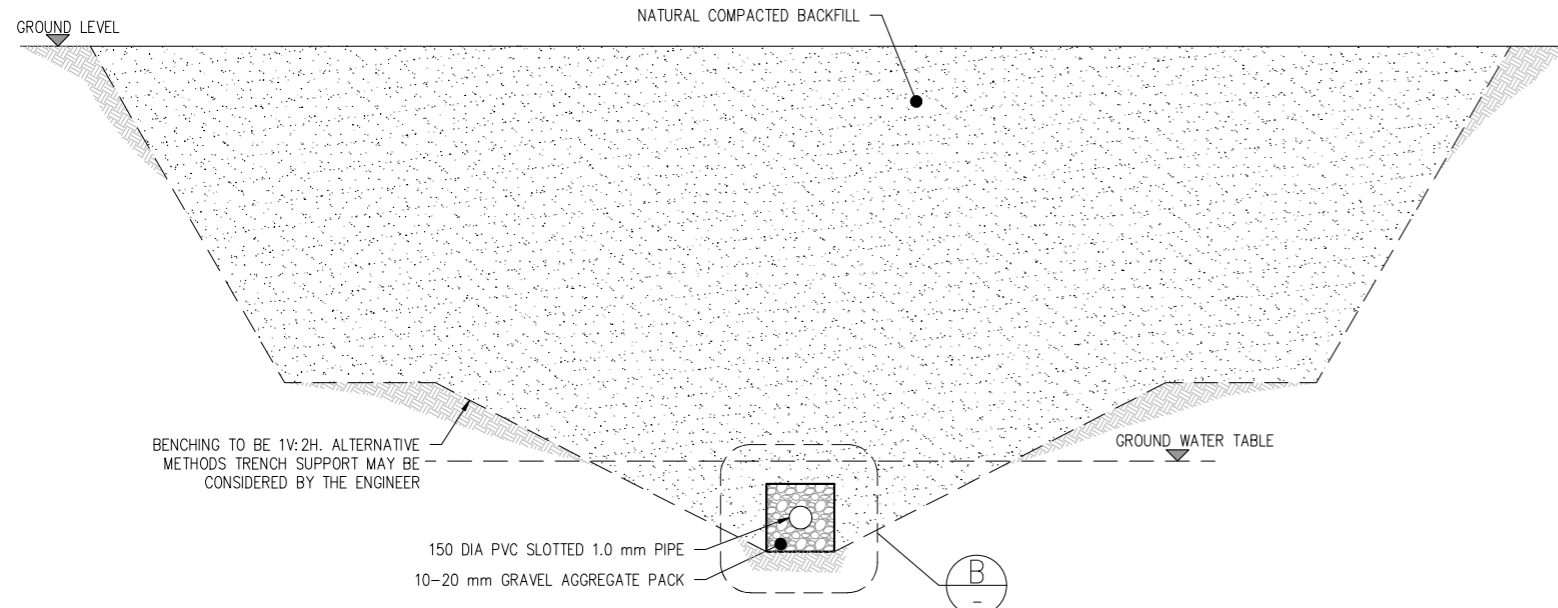

**1 TYPICAL TRENCH DETAIL-SECTION 1**  
SCALE 1:25

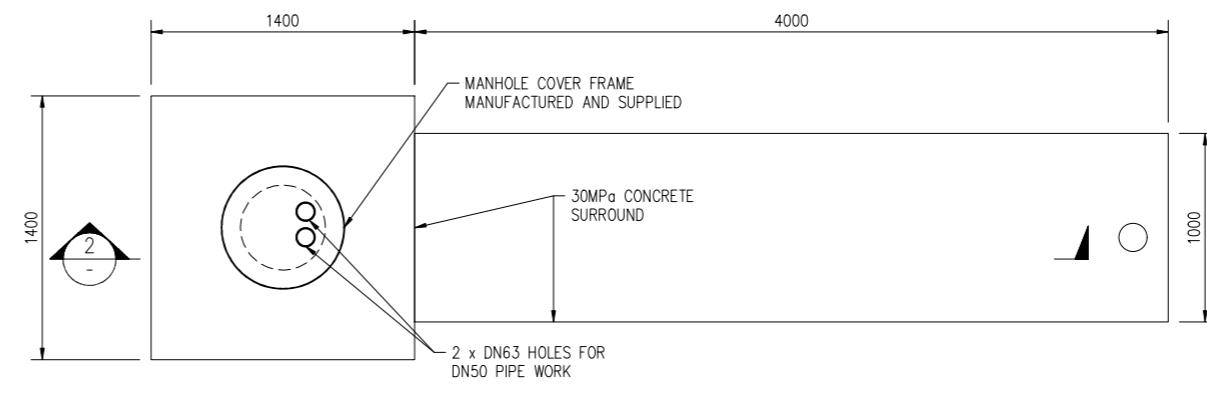

**WELL COVER DETAIL**  
SCALE 1:20

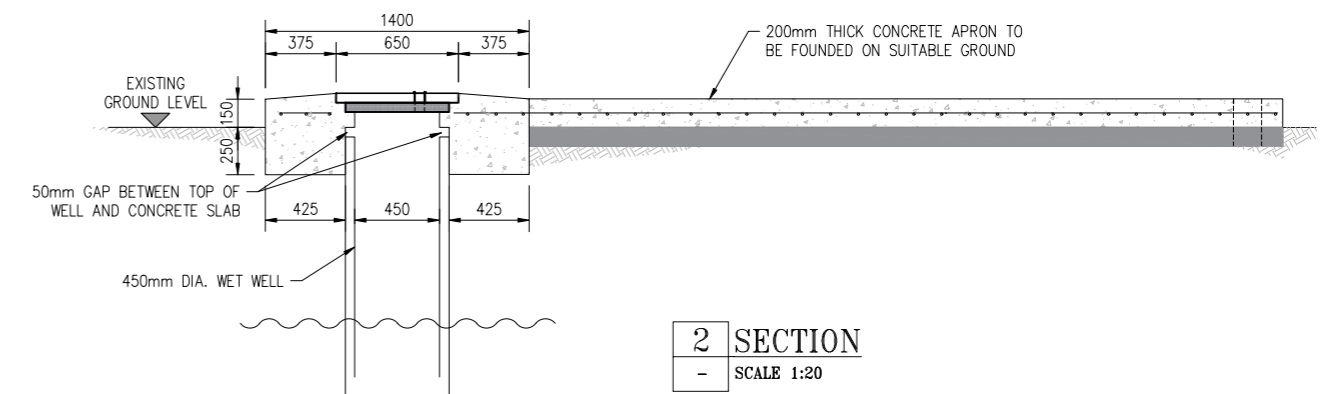

**2 SECTION**  
SCALE 1:20

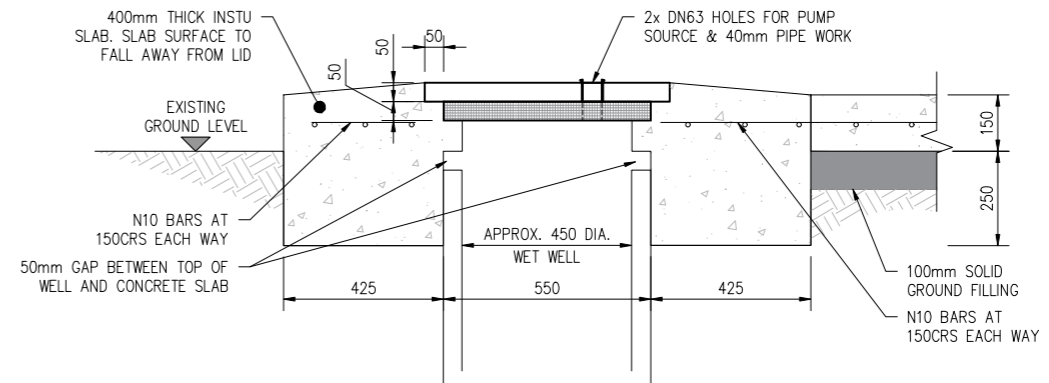

**A DETAIL**  
SCALE 1:10

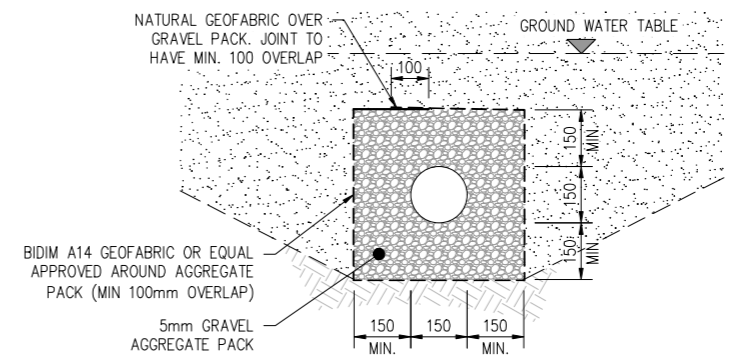

**B DETAIL**  
SCALE 1:10

- NOTE:**
1. ALL DIMENSION ARE IN MILLIMETERS UNLESS NOTED OTHERWISE.
  2. FINAL PIPE WORK LEVEL TO BE CONFIRMED ON SITE PRIOR TO CONSTRUCTION.
  3. ALL EXPOSED PIPELINE ARE TO BE POLYETHYLENE.
  4. PIPEWORK TO CONNECTED WITH PE COMPRESSION FITTINGS UNLESS NOTED OTHERWISE.
  5. ALL PE PIPE WORK AND FITTINGS TO BE CLASS PET100 SDR21 P8, UNLESS NOTED OTHERWISE.
  6. PIPEWORK TO BE CONNECTED WITH APPROVED COMPRESSION FITTINGS.
  7. ALL STEEL PIPE WORK AND FITTINGS TO BE 316 MARINE GRADE UNLESS NOTED OTHERWISE.
  8. CONCRETE IS TO BE 30MPa STRENGTH.
  9. PLASTIC DAMP PROOF COURSE (DPC) SHEETING PROVIDED BETWEEN ALL CONCRETE AND SOIL INTERSECTION.

DO NOT SCALE - IF IN DOUBT, ASK

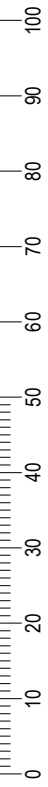

ORIGINAL SIZE A1

ISSUE	DESCRIPTION	CHECKED	APPROVED	DATE
0A	FOR TENDER	HS	NK	18.10.23

Client:

**Pacific Community**  
Communauté du Pacifique

**NRW MACALLAN (FIJI) LTD**  
CONSULTING ENGINEERS

CIVIL STRUCTURAL & PROJECT MANAGEMENT  
79 RATU MARA ROAD, SUVA  
P.O. Box 1208  
SUVA  
FIJI

TELEPHONE: (679) 3313388  
MOBILE: (679)  
FAX: (679) 3302903  
EMAIL: info@nrwmacallan.com.fj

Drafter:	HT	Designed:	-
Checked:	HSNK	Date:	23.08.23
Scale A1:	AS SHOWN	Scale A3:	HALF SHOWN

PROJECT:	MANAGING COASTAL AQUIFERS (MCAP), WOTJE, MARSHALL ISLAND
TITLE:	GALLERY DETAILS

JOB. NO:	22307117
REV. NO:	0A
DRAWING. NO:	A-008

Copyright © of this drawing shall remain the property of NRW MACALLAN. No part of this document may be reproduced or transmitted by any means without the prior permission in writing of NRW MACALLAN Ltd.



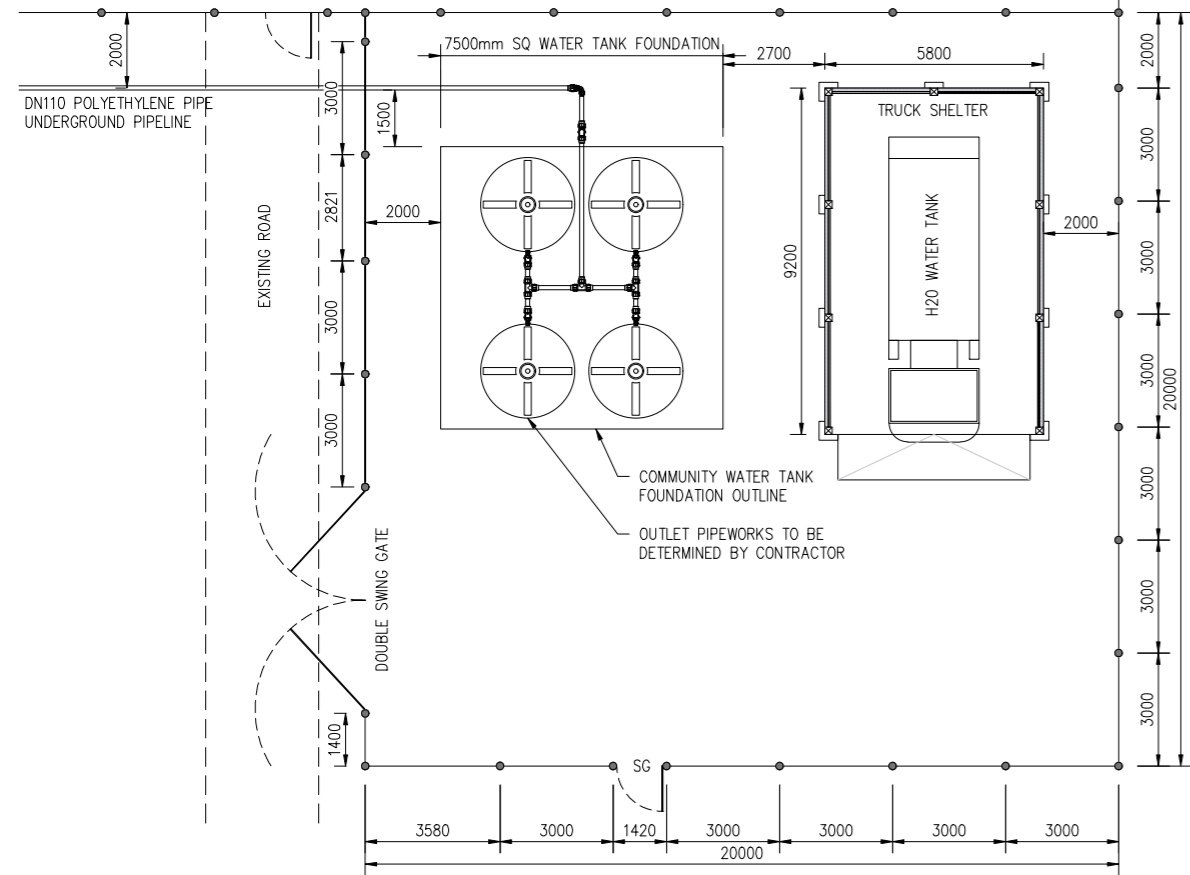

**SITE PLAN-COMMUNITY FILLING POINT**

SCALE 1:100

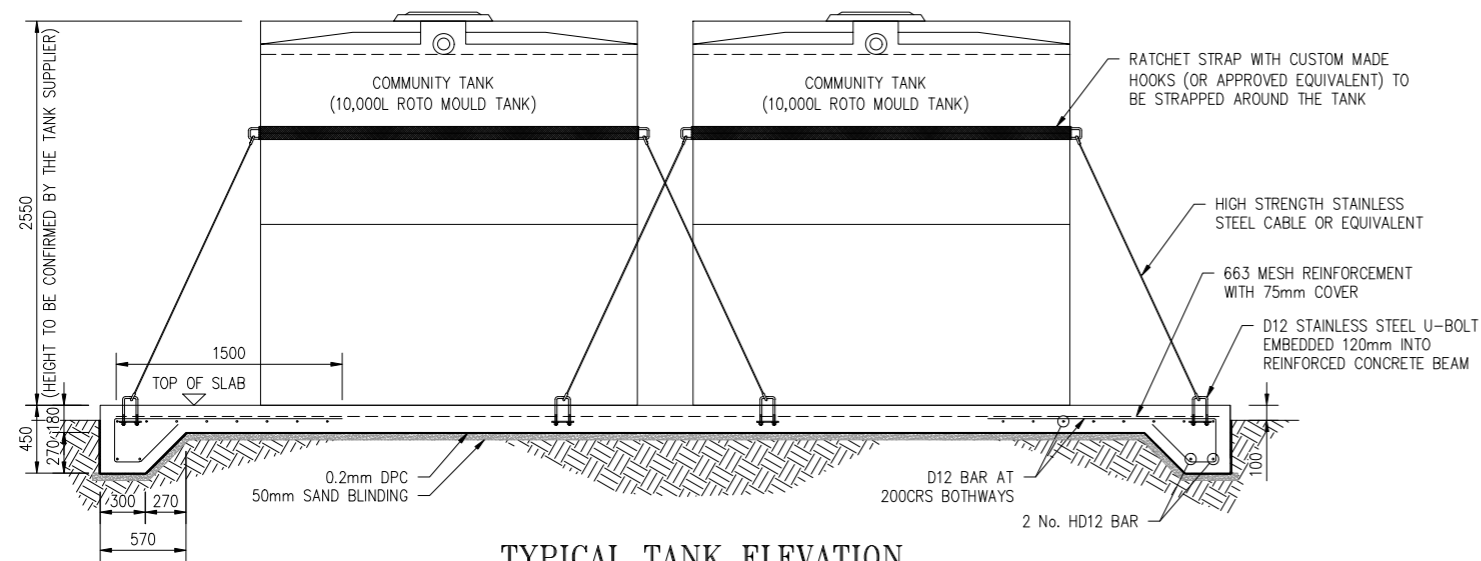

**TYPICAL TANK ELEVATION**

SCALE 1:25

**NOTE:**

1. ALL DIMENSION ARE IN MILLIMETERS UNLESS NOTED OTHERWISE.
2. PIPE AND STRUCTURE LEVELS TO BE CONFIRMED ON SITE BY THE ENGINEER.
3. BEFORE CONSTRUCTION, CONTRACTOR TO RE-CHECK EXISTING DIMENSION ONSITE.
4. CONTRACTOR TO SEEK DESIGNER APPROVAL IF CHANGES ARE MADE TO THE DRAWINGS.
5. ALL PIPE CONNECTION IS TO BE CONFIRMED BY THE ENGINEER PRIOR TO PROCUREMENT.
6. ANY OTHER CHANGES MADE APART FROM THE DESIGNERS APPROVAL, CLIENT WILL BARE EXTRA COST.

DO NOT SCALE - IF IN DOUBT, ASK

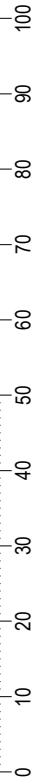

ORIGINAL SIZE A1

Copyright © of this drawing shall remain the property of NRW MACALLAN. No part of this document may be reproduced or transmitted by any means without the prior permission in writing of NRW MACALLAN Ltd.

ISSUE	DESCRIPTION	CHECKED	APPROVED	DATE
0A	FOR TENDER	HS	NK	18.10.23

Client:

**Pacific Community**  
Communauté du Pacifique

**NRW MACALLAN (FIJI) LTD**  
CONSULTING ENGINEERS

CIVIL STRUCTURAL & PROJECT MANAGEMENT  
79 RATU MARA ROAD, SUVA  
P.O. Box 1208  
SUVA  
FIJI

TELEPHONE: (679) 3313388  
MOBILE: (679)  
FAX: (679) 3302903  
EMAIL: [infor@nrwmacallan.com.fj](mailto:infor@nrwmacallan.com.fj)

Drafter:	HT	Designed:	-
Checked:	HSNK	Date:	23.08.23
Scale A1:	AS SHOWN	Scale A3:	HALF SHOWN

PROJECT: MANAGING COASTAL AQUIFERS (MCAP), WOTJE, MARSHALL ISLAND

TITLE: **COMMUNITY FILLING POINT SITE PLAN TYPICAL SECTIONS**

JOB. NO:	22307117	
REV. NO:	0A	DRAWING. NO: A-010